



Brake Circlip Installation Tool

MGB, TR7, Sprites, Midgets, Classic Mini 386-185 or 17H7949T

About this tool...

Wheel cylinders on many British cars are retained by a giant circlip. You can generally pry it off with a screwdriver but it takes special factory tools to put one on. We ran across this clever alternative and it has proved to be very handy. It comes disassembled, and you can quickly assemble it as shown in Figure 1. The threaded shaft (1d) goes through the body (1b) and the "spreader" (1a) goes on one end and the jam nut (1c) goes on the other.

Installation Tips & Suggestions

Remove the "spreader" (2a) and place the 326-720 or 17H7949 circlip (2b) on the threaded shaft and replace the "spreader" (2a). Note the relationship of the gap in the circlip and the bleeder screw.

Use a screwdriver to prevent the threaded shaft (2c) from rotating, and rotate the nut (2d) clockwise to force the body (2e) down over the "spreader" (2a).

The circlip will open up as it is forced down over the expanding taper of the "spreader". It will eventually be open enough to slide over the body of the wheel cylinder and it will eventually pop into the groove (2f).

Figure 3 shows the tool being used to install the circlip on the wheel cylinder with the backing plate in place.

The bleeder has been removed, leaving a hole (3a). Note the gap in the circlip in relation to the hole for the bleeder screw- the circlip is positioned to clear the bleeder.

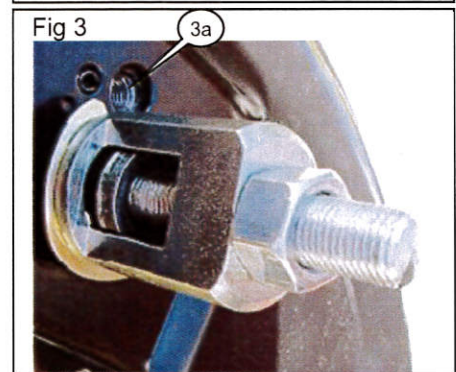
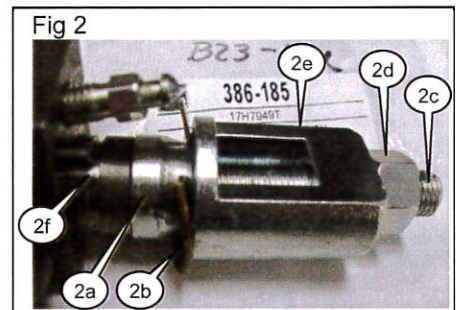
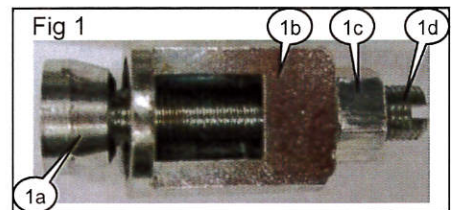

Although every effort has been made to ensure the accuracy and clarity of this information, any suggestions that you may have that will improve the information (especially detailed installation notes) are welcome. Please use the simple email form on the "Contact Us" page on the Moss website: <http://www.mossmotors.com/AboutMoss/ContactUs.aspx>. If you prefer, you may call our Technical Services Department at 805-681-3411. So many people call us for help that we are often not able to answer the calls as fast as we'd like, and you may be asked to leave a message. We respond to every call for help as quickly as we can, which is normally within 2 business days, but when the volume of calls and emails is high, it may take longer. We apologize in advance for the inconvenience.



Moss Motors, Ltd.

440 Rutherford Street, Goleta, California 93117

In the US & Canada Toll Free (800) 667-7872 FAX (805) 692-2510 (805) 681-3400

Moss Europe Ltd.

Hampton Farm Industrial Estate, Hampton Road West, Hanworth Middlesex, TW13 6DB

In the UK: 020-8867-2020 FAX: 020-8867-2030

Instruction Sheet Moss 386-185_17H7949T September 2014